



Specifikacije

Čipset	Qualcomm QCC5100 Series	
Ulaz	USB -C/Bluetooth 5.0 (AAC, SBC, aptX, aptX HD, aptX Adaptive, aptX LL, LDAC, LHDC/HWA Codec)	
Izlazi	4.4 mm/3.5 mm (bal/nebal) USB-C - 24 bit / 96kHz	
Izlazna snaga	Balansirani	245 mW @ 32 Ω; 5.6 V @ 600 Ω
	Nebalansirani	165 mW @ 32 Ω; 2.8 V @ 600 Ω
Izlazna impedanca	<1 Ω (bal/nebal)	
SNR	111 dBA/106.5 dBA (bal/nebal)	

DNR	120 dB(A) (bal/nebal)
THD + N	<0.009 % (BAL 6.5 mW/2.0 V @ 600 Ω) <0.03 % (nebal 100 mW/1.27 V @ 16 Ω)
Frekventni odziv	20 Hz 45 kHz (-3 dB)
Baterija	Litij-polimer, cca 450 mAh ~ 10 sati
Sistem punjenja	Punjenje putem USB-C usklađen do struje punjenja 1000 mA i 6.3 V
Dimenzije	55 x 34 x 13 mm
Masa	26 g

GO blu

Spajanje



Balansirane slušalice
4.4 mm

Single ended slušalice
4.4 mm

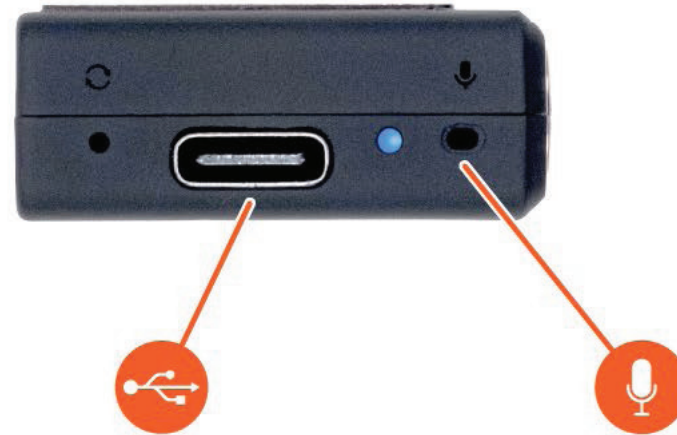

USB-C ulaz
24 bit / 96 kHz
Punjenje

Ugrađeni mikrofoni

GO blu

Bluetooth - LED



Priključeno

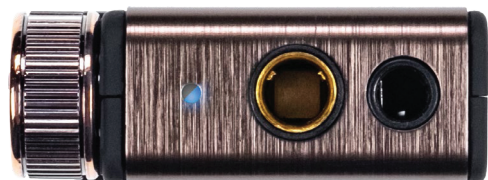

Plavo treptanje:
čekanje priključka



Treptanje plavo/crveno:
spajanje

Zvuk - LED

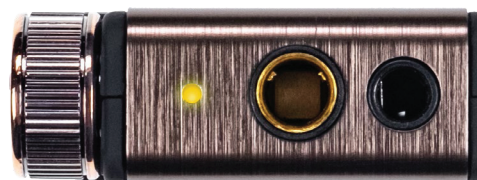

XBass



XSpace



XBass + XSpace



Precizni mikro enkoder za najbolji povratni osjećaj dodira

GO blu

Superiorni dizajn i komponente

Perfecting the Art of Electronics

ALPS®



10 hours

Litij-polimer baterija s visokom gustoćom energije

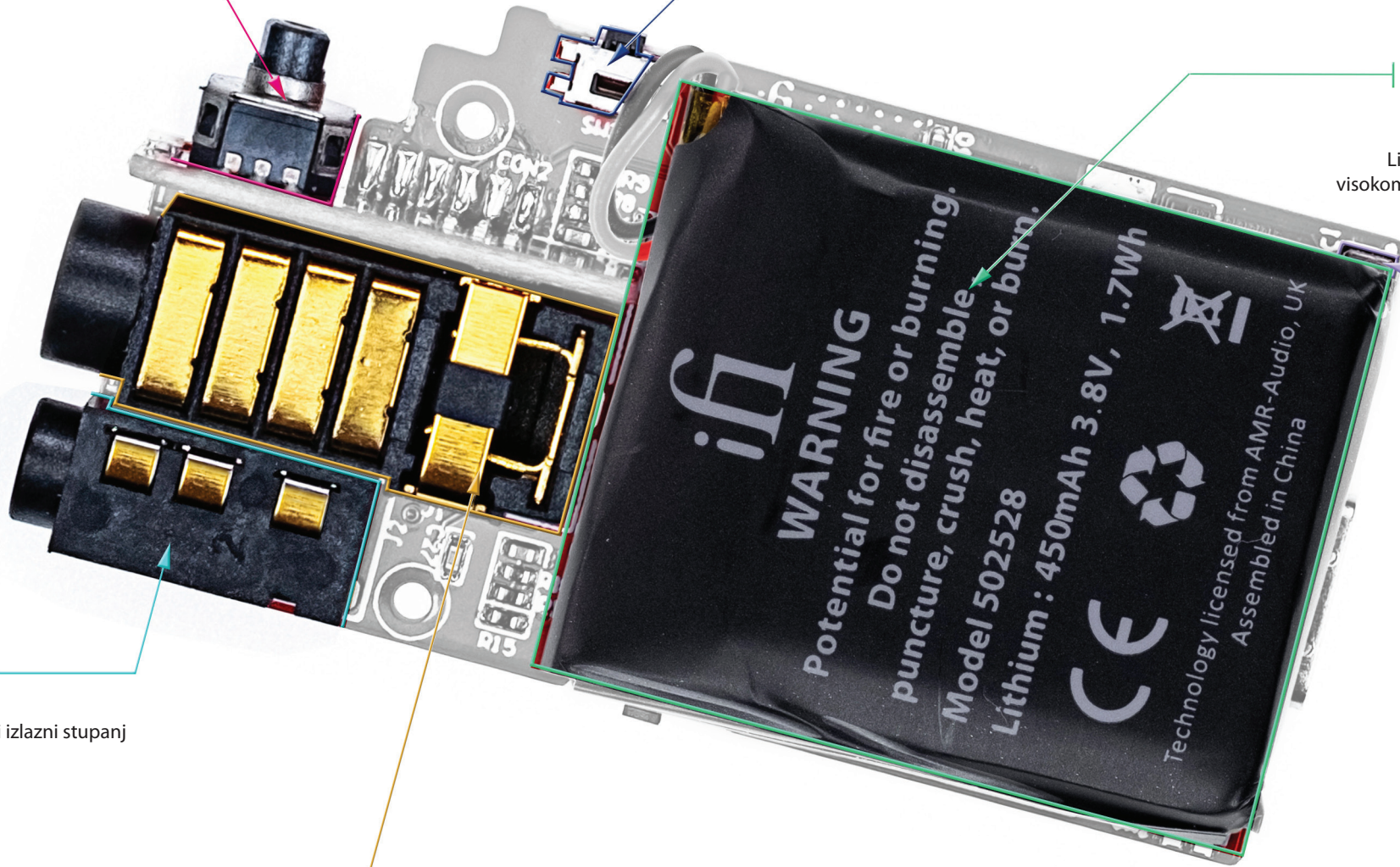

3.5 mm S-balansirani izlazni stupanj

Balanced

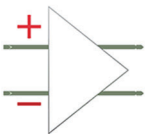

4.4 balansirani sklop

ifi
iFi audio

audiocinema art



Omnidirekcionani MEMS mikrofoni (mikroelektromehanički sustav)

ifi
WARNING
Potential for fire or burning.
Do not disassemble,
puncture, crush, heat, or burn.
Model 502528
Lithium : 450mAh 3.8V, 1.7Wh
CE
Technology licensed from AMR-Audio, UK
Assembled in China

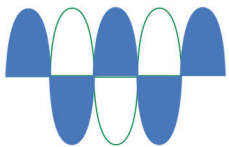

Dvostruka mono pojačala za najbolji balansirani učinak

GO blu

Superiorni dizajn i komponente

Master **HIFI**

FROM CIRRUS LOGIC

Namjenski 32 bitni Master HiFi DAC



Precizni vrhunski oscilatori s niskim jitterom

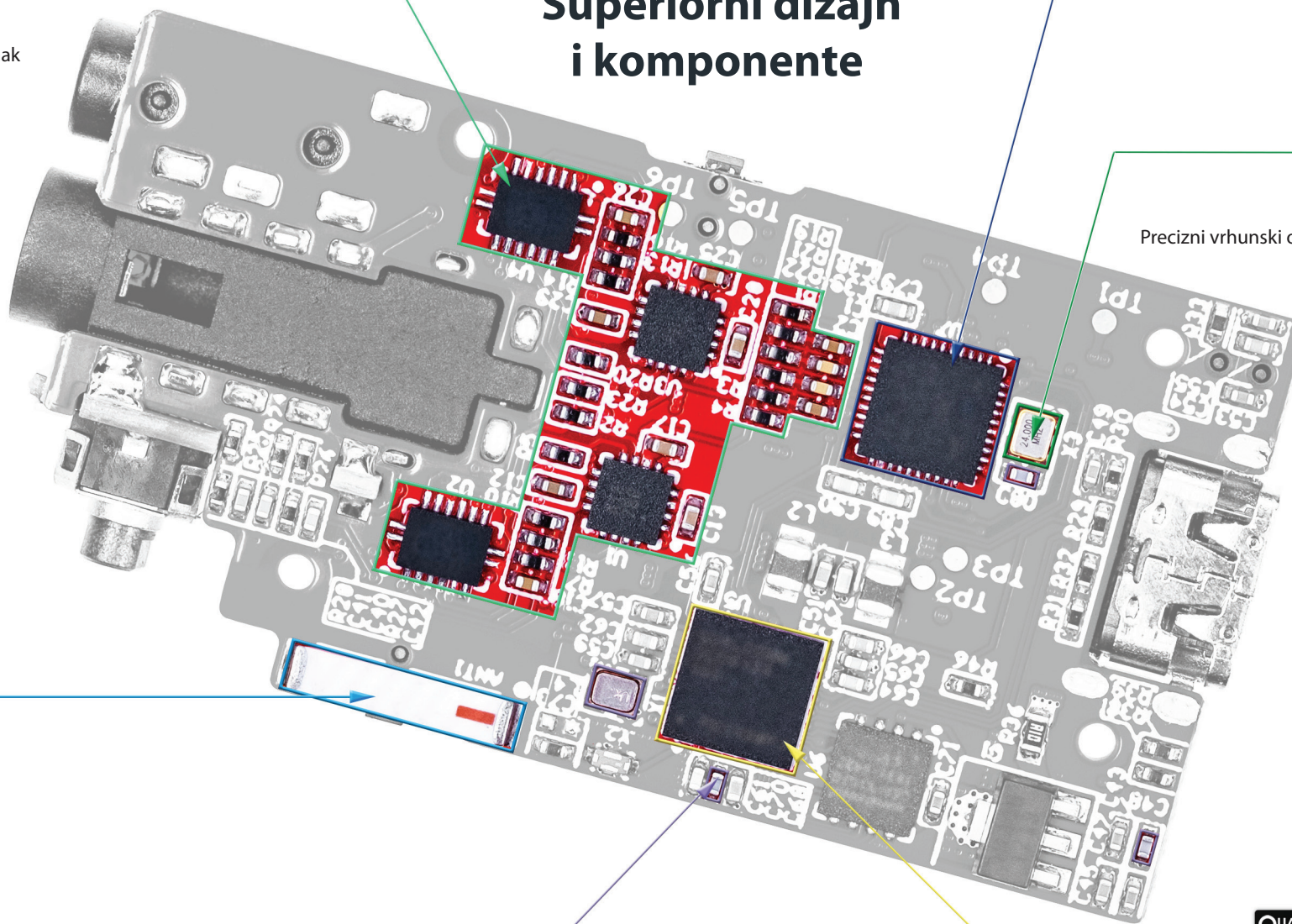

Antena s velikim pojačanjem

muRata

INNOVATOR IN ELECTRONICS



Murata višeslojni kapacitet (niski ESR i visoki Q)
- manji gubici energije i unutarnje zagrijavanje

audiocinema art

ifi

iFi audio



Qualcomm 5100 Bluetooth čip
Bluetooth 5.0® (aptX, aptX HD, aptX Adaptive, aptX LL,
LDAC, HWA/LHDAC, AAC i SBC)